

PLOT 7E OUTLINE ONLY: REFER TO PARAMETER PLANS & DESIGN GUIDE

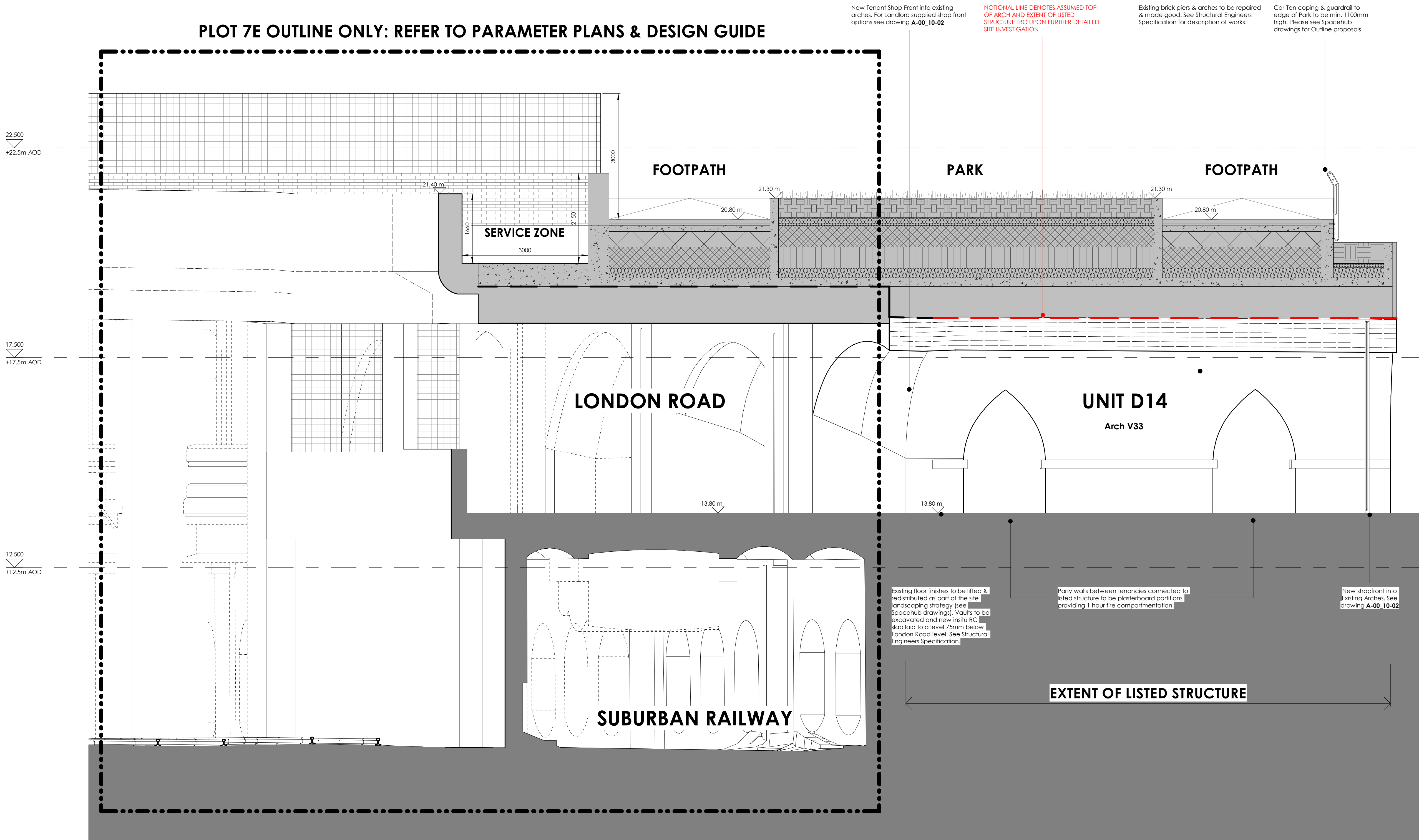

JACK ARCHED LID TO LONDON ROAD - This significantly contributes to the character of London Road and is generally to be retained and repaired with cut outs over the new Public Squares.

- KEY**
- AREA OUTSIDE SCOPE OF APPLICATION
 - REFER TO STRUCTURAL, M&E & LANDSCAPE CONSULTANT PROPOSALS FOR DETAILS
 - PROPOSED GOODYARD PLOTS OUTSIDE SCOPE OF PLOT 7 LBA
- NOTE:**
REFER TO SPACE HUB DRAWINGS FOR SITE-WIDE LEVELS, PUBLIC REALM & LANDSCAPING
REFER TO WSP DRAWINGS FOR SITE-WIDE ATTENUATION & DETAILS OF PODIUM LEVEL FOUNDATIONS
- REFER TO PLOWMAN CRAVEN SURVEY DRAWINGS:**
1.5532-010T-01 (A) - 3D Street Survey
1.5532-010T-03 (A) - Boundary Drawing
1.5532-010B-01 (A) - Viaduct Structure Plan
1.5532-010W-02 (A) - Railway Cutting
1.5532-013E-02 (A) - Brick Lane Elevations
1.5532-013T-01 (B) - Planimetric Survey
W15532-010SM - 3D Arch Survey
- FOR DETAIL OF ARCHES REFER TO:**
KMH HERITAGE STATEMENT & ALAN BAXTER CONDITION SURVEY

1 Plot 7D13 - Proposed Section
1 : 50



Do not scale this drawing
Do not derive dimensions from digital media

Rev	Date	Drawn By	Checked By	Rev	Date	Revision Notes	Drawn By	Checked By	Rev	Date	Revision Notes	Drawn By	Checked By	Drawing Status:	Suitability:	Drawing No:	Rev:
														PLANNING FOR LISTED BUILDING CONSENT	-	BGY-FBA-07-XX-DR-A-00_10-7D13	P1
														Job Title: The Goodyard	Job No: 3465	© Drawing & Design Copyright of: FAULKNERBROWNS ARCHITECTS	
														Drawing Title: Plot 7D - Proposed Section Sheet 3		FaulknerBrowns LLP Osborn House Northumbrian Way Killingworth Newcastle upon Tyne NE12 6DW T+44(0)191 2683007 F+44(0)191 2478132	
														Date: April 19	Scale: As indicated	Drawn By: SO	Checked By: PG